

type number: **SUP\_S**  
**SUP\_F**



product description: For the attaching of the cable ladder to the bracket.  
Two piece per bracket.

surface finish: S - Pre-Galvanized according to EN 10346, EN 10143, zinc-layer 15-27  $\mu\text{m}$   
F - Hot Dip Galvanized according to ČSN EN ISO 1461, zinc-layer 45  $\mu\text{m}$  (min. 35  $\mu\text{m}$ )

sales amount:: á 1 pc

storage: ČSN EN 60721-3-1

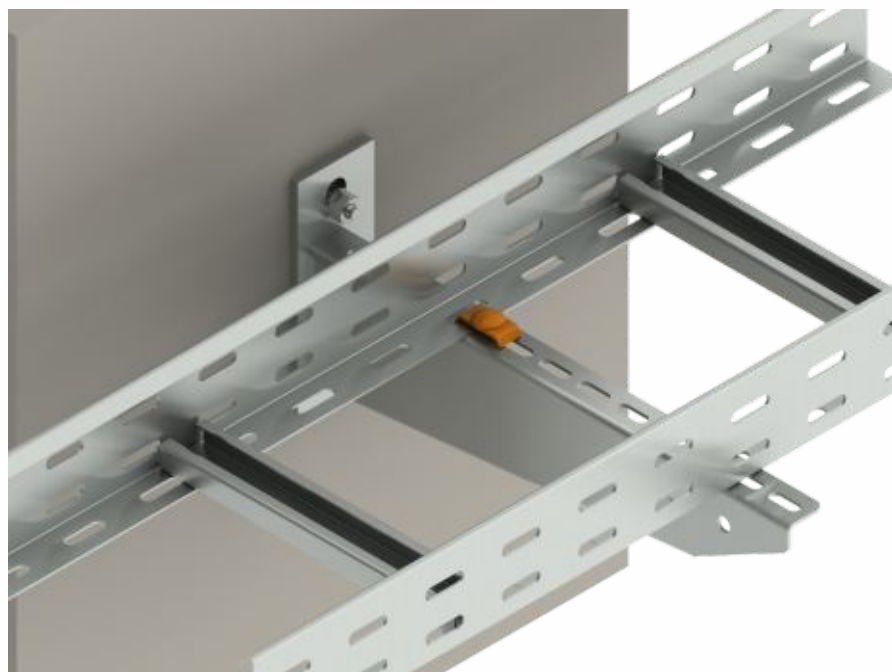
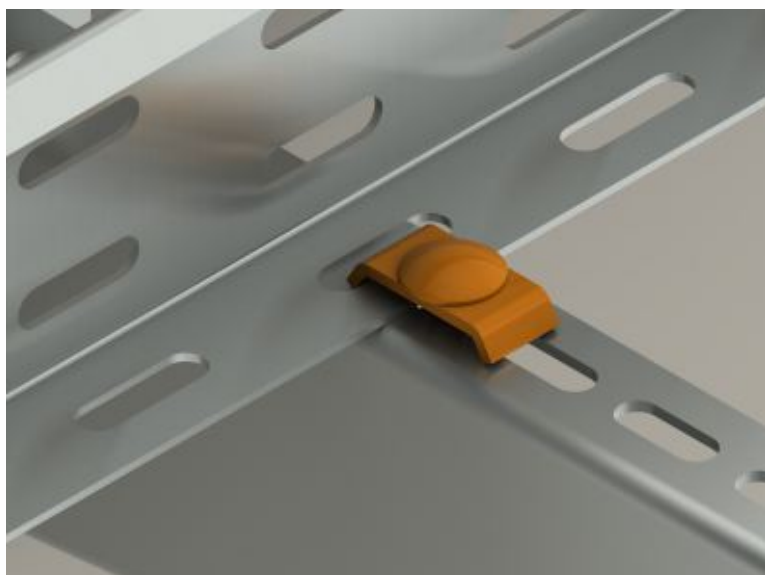

 **WARNING****Risk of injury from cutting**

Although the cable trays are produced with maximum effort to minimize sharper edges, it is necessary to wear protective gloves to carry, grip and work with cable elements.

**Risk of system collapse**

It is essential to strictly adhere to the maximum load limits for individual cable support systems and ensure proper installation according to the installation manual. The load capacity charts for each system are provided in the manufacturer's catalog, available in printed form or on the manufacturer's website. The specified load limits do not account for any additional loads, such as snow, wind, or seismic forces.

**Electricity injury**

As individual components of cable management systems are made of electrical conductive material, it is essential not to work with a system near live electrical parts. Infringement of the safety regulations may cause serious injury of health or death.

**Safe Use**

Under normal and foreseeable conditions of use, there are no risks to consumers, provided that proper installation and usage are carried out in accordance with the installation manual.

recycling codes:



fixation clamp



cardboard



plastic bag